

- 1 Audio Player On/Off
- 2 Flashlight On/Off
- 3 Previous Chapter
- 4 Next Chapter
- 5 Previous Book
- 6 Next Book
- 7 Previous Library (Language)
- 8 Next Library (Language)
- 9 Play/Pause
- 10 Volume Up/Down
- 11 Charge Indicator Lights
- 12 Headphone Output (AUX)
- 13 MicroUSB Input (Charging Device)
- 14 MicroUSB phone connector
- 15 USB-C phone connector



POWER ON/OFF

 Hold power button for 3 seconds



To power flashlight on/off, press the flashlight button



02.28.2025

Model: RW0AAPv1

Input: DC 5V / 1A

Capacity: 650mAh / 2.405Wh



Warning: Batteries should not be exposed to excessive heat such as fire.

CHARGE BATTERY

Tap power button to check battery level



Wall Charge: Plug in USB charging cable



Wall Charge Time =
About 2 hours

5 Lights =

1 Light =

Runtime =
(audio) 9 hours
(light) 20 hours

Solar Charge



Red charge light = solar charging
3 hours in the sun = 2 hours of audio

**Lights and audio must be off when solar charging*

CONNECT TO PHONE



Open the top corners of the device to access the USB-C or microUSB connector & connect to a cell phone

OPEN FILES

- 1 Pull down to open notifications
- 2 Select **USB storage** or drive

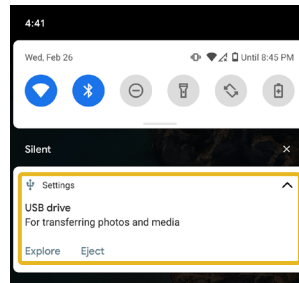

Select
Allow access
(on some phones)

NOTE: If USB storage is not in notifications, search for **Files app**, and select **USB storage**

INSTALL APPS

- 1 Select **app install file** (.apk or .adb file)

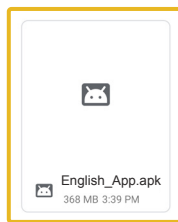

- 2 There will be a warning. Select **Continue**

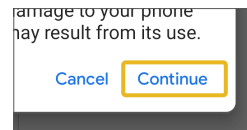

NOTE:

On some phones you must also enable "unknown sources" or "allow from this source" in settings.

- 3 Select **Install**

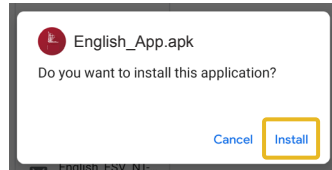

COPY FILES

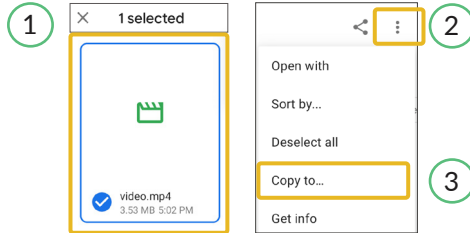

QUICK START